

INSTALLING YOUR LEATHER BAG INSERTS

STEP 1

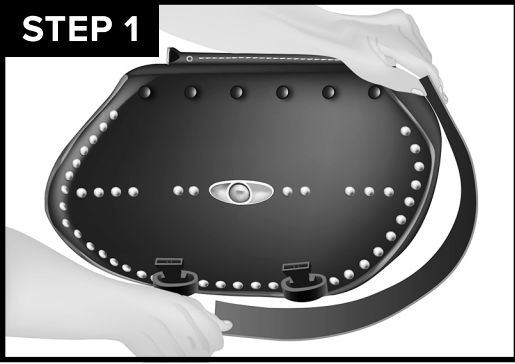

Step 1: Bag Inserts

Note: In Cold Weather Areas Use A Hair-Dryer To Warm Your Bag Insert Parts Before Bending. While Shaping, Bend the Bag Insert A Little At A Time According To The Shape Of The Saddlebag.

When Installing, the Hair-Cell Finish Will Be Facing-Out with the Smooth Unfinished Side Facing-In Toward The Leather. Please be sure to Read the Labels on Back Of Inserts for Proper Placement.

STEP 2

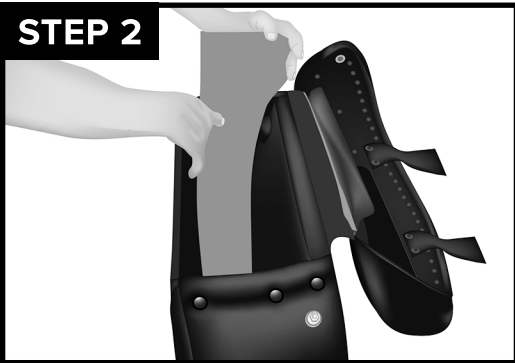

Step 2: Front Inserts

After Bending Your Saddlebag Inserts to the Shape of your Bag. Slide Your Front Insert Downward while trapping it between the Sew-Seam and the Closest Flat-Part of the Bag Leather.

STEP 3

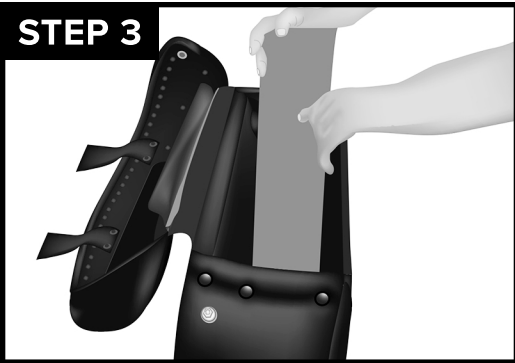

Step 3: Rear Inserts

After Shaping, put the complete Rear Insert down inside the Bag. While holding down the Insert into position with 1 hand. Using the other hand on the outside, bend the tips of your fingers into a claw-like-fashion. Use the tips of your fingers (starting @ the bottom)

Push the Piping & Sew-Seam Inward & Upward allowing the Sew-Seam to Stand-Up on the Inside. This will allow the Insert to push past the Sew-Seam for a Flat-Fit Against Your Bag Leather. Repeat this method until the Insert Is Trapped under the Sew-Seam.

STEP 4

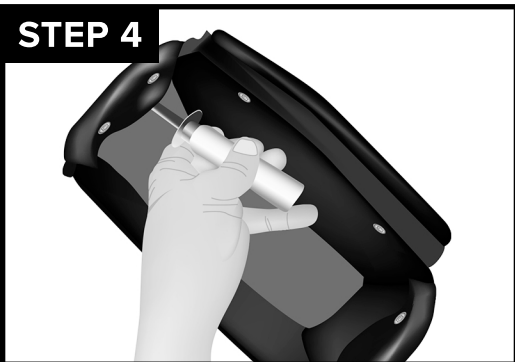

Step 4: Last-Step

After Trapping Your Saddlebag Inserts the Last-Step will be to Line-Up the Top of the Insert With The 2 Top Existing Bag-Rivets. Cover The Top of the Insert with the Top-Flap of your Saddlebag using an Oyster-Knife or Med. Flat-Blade Screwdriver. When covered, the Inserts will not be able to raise upward. This will cause the Insert to become completely trapped in place.

DISCLAIMER: All Inserts & Supports come in Sets to Fit Both Right & Left Saddlebags. All leather saddlebags are not stitched the same and due to Leather Shrinkage will vary a little in size. Therefore, our product is made as a One Size Fits All and will fit approx. 98% of the saddlebags made on the market. For the other 2% hand-snips will be required to trim. If you have any Questions please call the Home Office at (239) 543-8360. Any duplication of this product will be in violation of Patent Laws. Patent Pending Made In U.S.A.

Note: We have found that Most Saddlebags generally do not need any Side-Supports after Normal Install of the Combo-Kit Inserts. SIDE SUPPORTS: Are Cut To Fit Last... And are only necessary when the Side of Bag is still Caved-In after the Lid & Bag Install. Bend your Support to the shape of the Bag where the Belts & Buckles ride on the Bag. Dry-Run to Fit Inside @ the Bottom Sew-Seam and Tuck-Under the existing Upper Rail Support. After Dry-Run Is In Place. Score Draw a Line on either side of Support. Remove & Glue for Install.