

# INSTALLING YOUR LEATHER LID INSERTS

## STEP 4

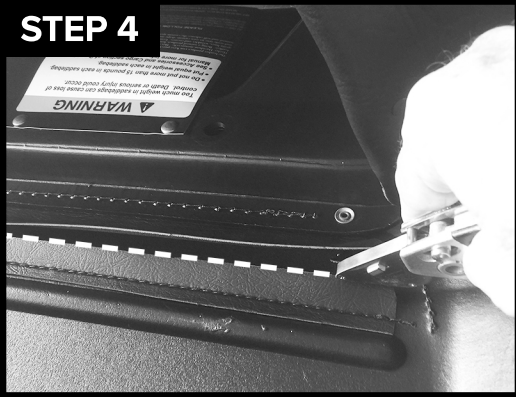

## STEP 1

Mandatory, Remove your Bags from the Bike for better control during Installation.

## STEP 2

Apply conditioner to the saddlebag, Mostly Inside including the Sew-Seams. This will allow the Leather to Relax and accept in Inserts for a better Install.

## STEP 5



## STEP 3

Lay the Bag facing up on a flat surface of your choice. Open the Lid toward you making sure the Lid is laying flat on the surface.

## STEP 4

Cut with Razor-Knife the Inside Hinge Flap using your Existing Lid-Cap As A Straight-Guide-Edge to maintain a straight line finish. Apply Conditioner Inside. No Glue Necessary for Lid-Insert Install when the Lid-Insert becomes Trapped.

## STEP 5

Install the Lid in between the existing Stock Plastic Cap & the Leather-Bag-Lid. Push the Lid-Insert inward until the curved part of the Lid-Insert bottoms-out. After the Lid-Insert is Trapped. Adjust Front to Rear to the Natural Fall of Lid.

## STEP 6

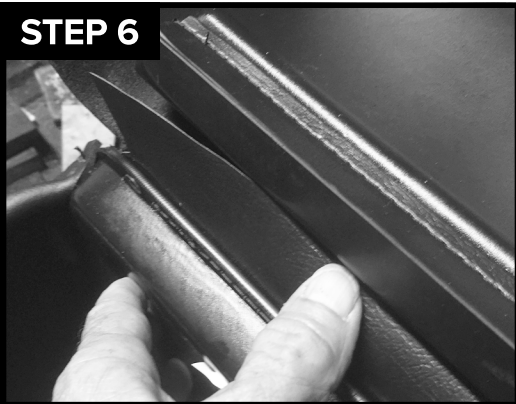

## STEP 6

Tuck the remaining Hinge Flap trapping it underneath the Installed Lid Insert.

## STEP 7

Close Bag Lid. Check the Look of the 1 in. 90 Degree Rear-Support. Adjust for Height if needed. Please Maintain Your SaddleBag Leather Every 6-Weeks.

**DISCLAIMER:** All Inserts & Supports come in Sets to Fit Both Right & Left Saddlebags. All leather saddlebags are not stitched the same and due to shrinkage will vary a little in size. Therefore our product is made as a One Size Fits All and will fit approximately 98% of the bags made on the market. For the other 2% hand-snips will be required to trim. Our Inserts come w/a Limited Life-Time Warranty. If you have any Qs. Please call the Hm. Office @ (239) 543-8360. Any duplication of this product will be in violation of Patent Laws. Patent Pending Made In U.S.A. Patent #D529, 431 S

**NOTE:** We recommend applying Leather Softeners & Conditioners before & after Installation. Your Saddlebags need a drink every 6-Wks. no matter how good you're surrounding weather conditions. It will help preserve & keep your bags from cracking, warping & drying-out. Keep your Bags Clean, Maintained & Well Preserved @ all times.